



LEADING THE FUTURE OF  
LIGHTING + TECHNOLOGY

# Emergency Lighting Tester (ELT)

Model ELITE-V1.5

Automated Compliance Monitoring for Emergency Fixtures

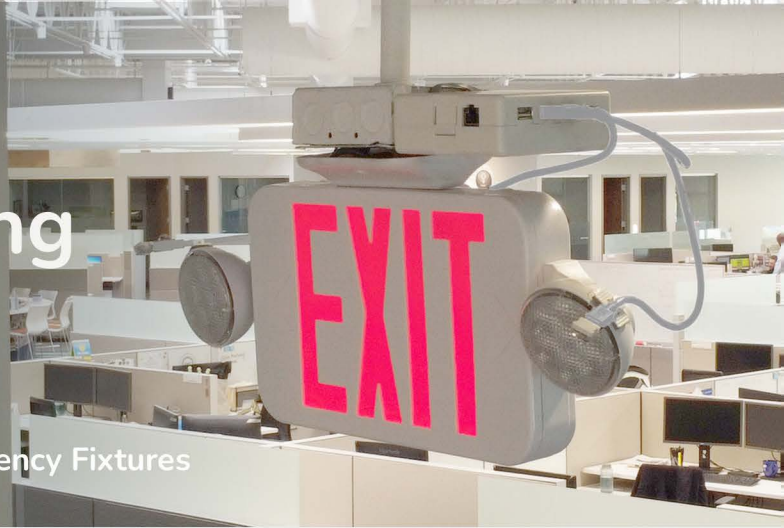

## Product Overview

The ELT-V1.5 is a retrofit node; it is UL924 listed and designed to automate emergency lighting compliance testing and reporting. It performs monthly function tests and annual duration tests in accordance with NFPA 101 standards, providing real-time status monitoring and automated digital reports.

## Key Features and Certifications



- UL 924 & UL 60730-1 Listed E544043
- FCC ID: SQG-RM1262
- NFPA 101 Life Safety Code Compliant
- 30-second and 90-minute test automation
- Compliance reporting
- Wireless communication to central gateway
- Fixture Health Monitoring
- Retrofit install
- Compatible with most emergency light fixtures

## Node Technical Specifications

- Input Voltage: 120-277V AC
- Radio: RM1262 is a compact, ultra-low power LoRaWAN module designed for high-performance, long-range wireless communication
- Processor: NXP Arm Cortex M33
- Power Draw (Peak/Max): ~15-20W
- Communication: LoRaWAN (868/915 MHz)
- Dimensions: 4x4.3x1.6 in (LxWxD)
- Weight: Less than 1lb
- Operating Temperature: 0°C to 50°C (32°F to 122°F)
- Mounting: Integrated into fixture via knockout or standard junction box (J-box) installation.
- LED Indicator: Status visible from ground level
- Material: (PC+ABS)-Blend; flame retardant enclosure
- Ability to monitor non-exit battery backup fixtures via extension module

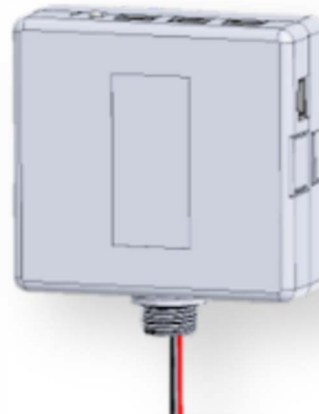

- Gateway Connectivity: Connects via Ethernet or, optionally, cellular (LTE) for sites lacking local network access.
- Cloud Integration: Devices link to a secure cloud platform enabling remote monitoring, reporting, and centralized data storage, with real-time dashboard access provided through a web portal.

IoT SOLUTIONS

# Gateway Technical Specifications



## Connectivity

LoRaWAN, Wi-Fi, Optional LTE (US only)

## Channels

8

## Operating Systems

Embedded Linux (Kernel 6.x)

## Package Forwarder Support

Supports Netmore (Senet), The Things Network (TNN), ChirpStack, AWS IoT Core for LoRaWAN, Actility ThingPark and Semtech UDP packet forwarders

## Wireless Standards

LoRaWAN IEEE 802.11a/b/g/n (Wi-Fi)  
Optional LTE (US only)

## Range

Up to 10 miles (line of sight)

## Wireless Chipsets

LoRa: Semtech SX1301 / SX1257  
Wi-Fi: CSR8811 A08, QCA6004  
LTE (Optional – US Version): Quectel EG91-NA

## Transmit Power

+27 dBm

## Network Interfaces

Ethernet, Wi-Fi, Optional LTE Power

## Power

External DC power supply

## ELT Network Architecture

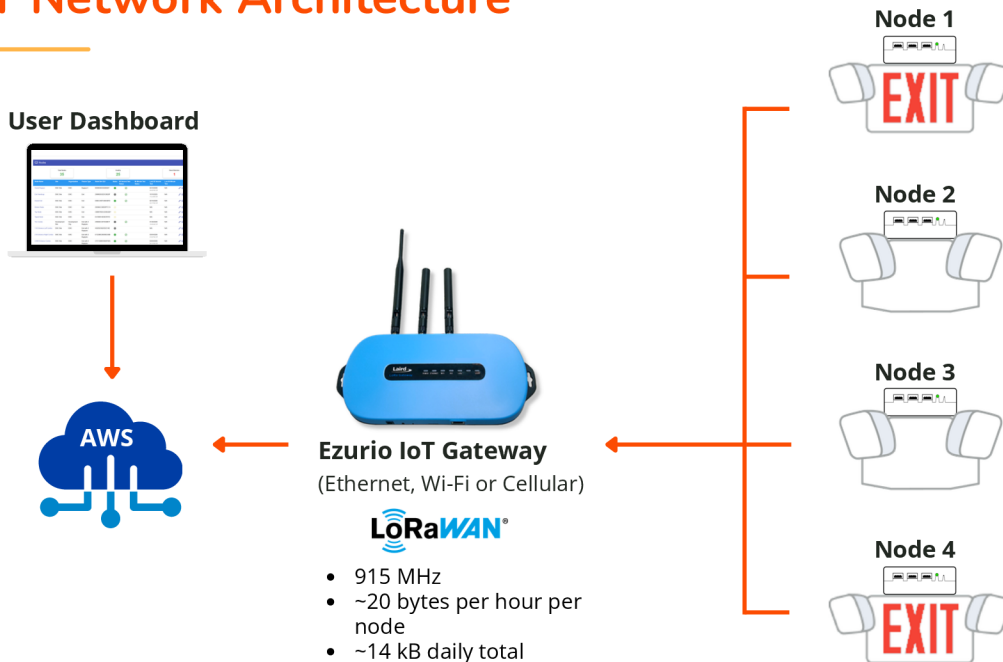

## Installation

- Plug-and-play installation into existing emergency light fixture
- Works with both wall packs and troffers
- Self-install or contractor-installed options

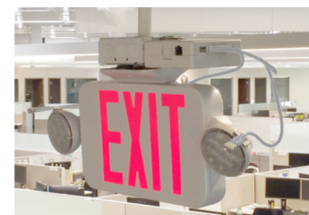
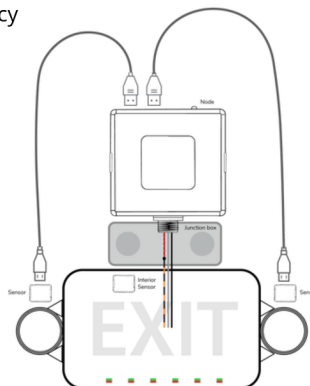

## Support + Resources

Tech Support Email: [elite.support@emcllc.com](mailto:elite.support@emcllc.com)  
Product Manager: Karisa Fehrmann  
Contact: [KFehrmann@emcllc.com](mailto:KFehrmann@emcllc.com)